

ATLAS OVERVIEW WEEK

PRAHA, CZECH REPUBLIC

13TH-19TH SEPTEMBER 2003

LAST INFORMATION

The official meeting web page:
<http://www.particle.cz/aw2003>

WELCOME TO PRAGUE

We hope that Prague, the host city of this meeting, will provide all the participants with a good basis for a scientific as well as a cultural and social experience. We believe that you will find its atmosphere as inspiring as have found many visitors in its new and old history.

MEETING SITE

The **ATLAS Overview Week** will take place at the Faculty of Mechanical Engineering of the Czech Technical University (CVUT) in Praha 6 - Dejvice, Technická Street 4 (<http://www.particle.cz/aw2003/index.aspx?page=map#meetingsite>). It is located in the western part of Praha (<http://www.particle.cz/aw2003/index.aspx?page=map#prague>).

REGISTRATION

Registration & Information desk will be open at the Czech Technical University, in the Room No. 132 on the 1st floor on Sunday afternoon, 14th September 2003 from **13:30 to 18:30**. There will be also an opportunity to register on Monday, 15th September 2003 from **08:00**. The registration desk will be open during the whole meeting programme and will help you to solve all matters connected with your stay in Praha.

We strongly recommend the participants to register during Sunday afternoon, when the registration desk should be more accessible and any problems may be settled more easily. On Monday morning the official meeting programme starts **at 09:00**.

PAYMENTS

All participants will be informed about the status of their payments and accommodation reservation before the beginning of the meeting. All financial problems (overpayments, payments due) have to be settled at the registration desk after arrival. Please take into account that we are not able to secure your accommodation without a pre-payment for the first night at least. The dead-line for early payments was 30th June 2003.

Payment is possible in cash, i.e. CZK, USD, EUR, in Travellers' Cheques, personal cheques and by VISA, Diners Club, JCB, American Express and Euro/MasterCards.

A written **Confirmation on Payment** will be issued on request by the organisers.

All payments by bank transfer, which were not sent **free of bank charges to the receiver** as well as the payments by **cheques** will have had administration charges debited by the bank. These charges should be covered at the registration desk. A copy of the corresponding bank statement can be provided upon request.

LANGUAGE

English will be the official language of the meeting. No translation service will be provided.

COMPUTER AND INTERNET SERVICES

A computer centre with access to the internet will be available to the participants, in connection with printing facilities. This centre will be located on the second floor in Room No. 207. You must use the side staircase in the A1 part of the building either from the first floor or from the third floor (see the building plan). It is not possible to enter the centre through the main corridor on the second floor. The centre will be open from Friday 12 to Friday 19 September, each day from 8:00 to 19:00 hours with exception on Wednesday 17 and Thursday 18 to 16:00 and on Friday 19 to 15:00. A possibility to connect notebooks to the Ethernet will be also available in the centre.

A wireless DHCP ethernet access will be available in all meeting rooms and their immediate vicinities. People must register their wifi network interface MAC address. Some have already done it during registration.

COFFEE BREAKS

Coffee and tee will be served during the morning and afternoon coffee breaks (according to the programme) in the foyer.

LUNCHES

Friday – Sunday (12th – 14th September 2003)

Lunch from Friday 12 to Sunday 14 is not included in the fee and will be served in the restaurant of the Masarykova kolej, Thakurova 1 Street. The walking distance is about 5 min from the meeting site (<http://www.particle.cz/aw2003/index.aspx?page=map#meetingsite>).

Monday – Friday (15th – 19th September 2003)

Lunch from Monday 15 to Friday 19 is included in the fee and will be served at the student's canteen "Studentský dům" in Bílá 6 Street (<http://www.particle.cz/aw2003/index.aspx?page=map#meetingsite>), the walking distance is about 5 min from the meeting site. Participants will find the lunch vouchers in the workshop packet given out at registration. Lunches will only be given upon exchange of these vouchers. We would appreciate if participants who will not have lunch on Friday could return their Friday vouchers to the registration desk.

PRESENTATIONS

All speakers are kindly asked to upload all their presentations on the CERN Agenda system. The presentations will be downloaded from the Agenda and displayed during their presentations. In case of plastic transparencies we will try to arrange scanning into a computer form before the presentation. It will need some time. A standard overhead projector will be also available. A possibility to project video cassettes VHS PAL format, DVD or CD media will also be available. All audio/video productions must be checked well ahead before the actual use.

VIDEO BROADCAST

The Commissioning workshop and all the plenary meetings will be broadcast over internet. The broadcast service is operational and you can access it on the address <http://www.particle.cz/aw2003/index.aspx?page=med>, where you can download necessary software if needed. You can test the connection now and you should see a few film shots from places in Prague that you will probably visit during your stay.

MEET PEOPLE!**WELCOME PARTY**

will take place in the Conference hall of the "Masarykova kolej" (<http://www.particle.cz/aw2003/index.aspx?page=map#meetingsite>) on **Sunday evening, 14th September 2003 from 18:00**. The party is included in the conference fee. The address is: Thakurova Street 1, Praha 6.

CONCERT & RECEPTION

The concert will take place in the historical Karolinum on **Monday evening, 15th September 2003 from 19:00**. The address is Ovocný trh 3, Praha 1, (<http://www.particle.cz/aw2003/index.aspx?page=map#karolinum>).

The rector of Charles University Ivan Wilhelm will welcome the participants in the Karolinum and will offer a glass of wine after the concert.

Perform: Nostitz Quartet

Programme:

Josef Suk: *Meditation on the Old Czech chorale "Saint Wenceslas"*

Joseph Haydn: *String Quartet Op.77 No.1 G dur*, Allegro moderato, Adagio, Menuetto.Presto, Finale.Vivace

F. Mendelssohn-Bartholdy: *String Quartet Op.13*, Adagio.Allegro vivace, Adagio con lento, Allegretto con moto, Presto

The M. Nostitz Quartet was founded in October 1994 by students of the Prague Academy of Music. It has been appearing in its current line-up with **Petr Bernášek** as first violin, **Václav Vacek** as second violin, **Pavel Hořejší** on the viola and **Petr Šporcl** on the cello since 1999. The quartet has since the start been guided by cellist Václav Bernášek, a member of the Kocian Quartet. Since January 1996, with the kind permission of Countess Mathilda Nostitz whose family was one of the greatest patrons of the arts in the 18th and 19th centuries, the quartet has been named after her. Since 1995, the four musicians have attended several times master classes in Reichenau, Austria, receiving instruction from members of the Amadeus Quartet, Bartók Quartet, Alban Berg Quartet and the City of Prague Quartet. In the academic year 1996/97 they started to study at the Hochschule für Musik und Darstellende Kunst in Vienna where for three years they studied chamber music play with Professor Pichler, leader of the Alban Berg Quartet, and with the violist Professor Kakuska. In May 1997, the quartet won the first prize in the Charles Hennen Concours, an international competition of chamber ensembles in Heerlen, Holland. This earned it an invitation to the Orlando Festival in Kerkrade, Holland in August 1997. In May 1998, the quartet won the second prize in the international competition at the Prague Spring Festival and the prize for the best interpretation of a Martinu quartet. In June 1998, they won the first prize in an international competition in Cremona, Italy. In autumn 1997 the quartet, together with several other orchestras, took part in the Days of Prague Culture in Kyoto, Japan. Together with the Wihan Quartet they appeared at the 2,000th concert of the Czech Association for Chamber Music at Prague's Rudolfinum Hall. The Quartet has been appearing regularly across the Czech Republic and Europe, in countries like Germany, France, Austria, Holland, Spain and Portugal.

DINNER

The dinner will take place in the Rothmayer Hall at Prague Castle (<http://www.particle.cz/aw2003/index.aspx?page=map#praguecastle>) on **Thursday evening, 18th September 2003**. The dinner is included in the registration fee.

16:30 – meeting point at the Hradcanské Square (a group photograph, meeting with guides and sight-seeing of Prague Castle)

20:00 – dinner in the Rothmayer Hall

TECHNICAL EXCURSIONS

Laboratory Visits will be held during Wednesday afternoon, 17th September 2003. Departure of buses from the Meeting site is at 16:00 and arrival back to the Meeting site at 19:45.

You can choose one from the two places:

- A - the Institute of Physics AS CR and the Faculty of Mathematics and Physics of the Charles University in Prague
- B - the Institute of the Experimental and Applied Physics of the Czech Technical University in Prague

You will visit the following places in the institutes:

- A - Institute of Physics of the AS CR (Na Slovance 2, Praha 8)
 - *Prague Asterix Laser System* (PALS) a laboratory providing the basis for experimental research in the field of high-power lasers and their applications.
 - Centre for Particle Physics of the Institute of Physics AS CR
 - *ATLAS Prague Pixel Lab*; a site for testing of pixel detectors for ATLAS;
 - **ATLAS Prague Strip Detector Lab**; a site for testing of strip detectors for ATLAS, development of low voltage system for SCT.
 - Institute of Particle and Nuclear Physics, Faculty of Mathematics and Physics of the Charles University in Prague (V Holešovičkách 2, Praha 8)
 - *ATLAS SCT Endcap* module quality assurance site, where standard tests for the endcap module production QA are performed (clean room, climate chamber, VME readout system, environmental monitoring system). Besides standard tests special testing methods of semiconductor detectors (laser, source) have been developed and used
 - *Van de Graaff* accelerator lab (accelerator, polarised deuteron target, experimental few-nucleon physics, radiation-hard detector studies)
- B - Institute of the Experimental and Applied Physics of the Czech Technical University in Prague (Horská 3a/22, Praha 2)
 - *ATLAS SCT Endcap* module quality assurance site, where standard tests for the endcap module production QA are performed (clean room, climate chamber, VME readout system, environmental monitoring system).
 - *MEDIPIX lab*
 - *laser tests* room

PRAGUE WALK

The walk through scientific historical places of interest in Prague will take place on Wednesday afternoon, 17th September 2003 concurrently with the technical excursions and will be guided by physicists (<http://www.asu.cas.cz/~had/pap.html>).

The participants will meet at Karolinum, Ovocny trh 3, Praha 1 at 17:00

(<http://www.particle.cz/aw2003/index.aspx?page=map#karolinum>).

LECTURE: PRAGUE AND THE UNIVERSE

The lecture Prague and the Universe by Jiri Langer will be held at the Meeting place, Technická 4, at Room No. 256 at 20:00. Jiri Langer is a well known Czech theoretical physicist specialized in general and special relativity and interested in philosophy and history of science.

TOURS

Unfortunately all tours had to be cancelled due to low interest. Money will be refunded to participants who have already paid for tours. There are several travel agencies in the centre of Praha, which organize similar excursions for individual clients, and it is relatively simple to secure an excursion on site. Let us know if you require assistance.

TRANSPORT in Praha

Convenient airline connections exist between Prague and all European and most of the world capitals. A flight schedule of the Czech airline company CSA can be found on the web page www.czech-airlines.com.

Information on the bus and train connections is available on the web pages both in Czech and English languages www.jizdnirady.cz or www.cdrrail.cz

Public Transport in Praha

(See also the web site: <http://www.dp-praha.cz>)

All participants will find one 7-day ticket (for trams, buses and metro) in their conference packet.

Underground, bus, and tram

Prague is a compact city (at least from the sightseeing point of view) with a very good public transport system. The underground (metro) runs three lines from 5:00 to midnight. The trams and buses run on a similar schedule. During the night special night trams and buses operate.

Tickets:

The same kind ticket is usable on the metro, tram and bus. You cannot purchase tickets inside the trams or at the tram stops (however, there are some exceptions); you have to buy them in advance at the tobacconist's or at the metro stations. However, it is possible to

buy tickets on the buses, at higher price. When you board the tram (bus, metro) validate a ticket in the yellow box near the entrance doors.

The price of a **no-change ticket** is **8 CZK**. This ticket is valid for 15 minutes only. In the underground, this ticket enables you to change from one underground line to another, but it is valid for the distance of 4 stations only.

The price of an **ordinary ticket** (with free changes among underground, bus, and tram lines) is **12 CZK** (an additional sale in buses 15 CZK). This ticket is valid for 60 minutes only, on night routes and on Saturdays and Sundays the validity is extended to 90 minutes.

It is also possible to buy a **short-term season ticket**, e.g. in the metro entrance halls of some main stations (no photo needed): a 1-day ticket (70 CZK), a 3-day ticket (200 CZK), a 7-day ticket (250 CZK), or a 15 days ticket (280 CZK).

Taxi:

The price is about 22 CZK for 1 km plus an initial charge 30 CZK, but the prices are not fixed and can differ considerably. Ask for an approximate price in advance – there is a danger of being overcharged. The taxi journey from the airport to the meeting site should cost a maximum of 300 - 400 CZK. The Praha airport Ruzyně is about 15 km from the city centre and is normally served by so called “airport” taxis. Alternatively, you may order for example a taxi service AAA Radiotaxi individually on the phone number 14014 or the phone number 222 333 222 or HALO TAXI with a phone number 244 11 44 11. In that case the taxis will arrive for you at the far right end of the arrival airport building when you exit it.

ACCOMMODATION

KRYSTAL hotel

Address: Jose Martího Street, Praha 6 – Veleslavin (<http://www.particle.cz/aw2003/index.aspx?page=map#krystal>)

Phone: +420 220 563 411

Hostel MASARYKOVA KOLEJ

Address: Thakurova Street 1, Praha 6 – Dejvice, (<http://www.particle.cz/aw2003/index.aspx?page=map#meetingsite>)

Phone: +420 233 051 111

HOW TO REACH your hotel from the airport “Praha – Ruzyně”

KRYSTAL

Take bus No. 119 or No. 179 and get off at the stop „Divoka Sarka“. Here change to tram No. 26 and go to the stop “Nad Džbanem”

MASARYKOVA KOLEJ

Take bus No. 119 or No. 179 and get off at the stop „Divoka Sarka“. Here change to tram No. 26 and go to the stop “Thakurova” or get off from the bus No. 119 at the terminal stop “Dejvicka” and go back along the Evropska Street (about 300m).

HOW TO REACH YOUR HOTEL from the railway station “Hlavní nadraží”

KRYSTAL

Take metro in the direction “Nadrazi Holesovice” to the station “Vltavska” and here take tram No. 26 and get off at the stop called „Nad Džbanem”.

MASARYKOVA KOLEJ

Take metro in the direction “Nadrazi Holesovice” to the station “Vltavska” and here take tram No. 26 and get off at the stop called „Thakurova”.

HOW TO REACH YOUR HOTEL from the railway station “Nadrazi Holesovice”

KRYSTAL

Take the metro, get off at the station “Vltavska” and here take tram No. 26 and get off at the stop called „Nad Džbanem”.

MASARYKOVA KOLEJ

Take the metro, get off at the station “Vltavska” and here take tram No. 26 and get off at the stop called „Thakurova”.

HOW TO REACH the meeting site

from hotel Krystal

Take any tram going down the hill from the stop “Nad Džbanem” and get off at “Vítězné náměstí” or “Thakurova”.

from the airport Praha - Ruzyně

Take the bus No.119 to the terminal Dejvicka, now it is within a walking distance.

from the railway station “Praha – Hlavní nadraží”

Take metro in the direction “Nadrazi Holesovice” to the station “Vltavska” and here take tram No. 26 and get off at the stop called „Thakurova”.

from the railway station “Praha – Holesovice”

Take the metro, get off at the station “Vltavska” and here take tram No. 26 and get off at the stop called „Thakurova”.

HOW TO REACH your hotel from meeting site

KRYSTAL

Take the tram No. 2, 20 or 26 from the stop “Thakurova” or “Vitezne namesti” in direction “Divoka Sarka, Cervený vrch” and get off at the stop Nad Džbánem”.

MASARYKOVA KOLEJ

The hostel is placed within a walking distance – about 5 min.

HOW TO REACH downtown from the meeting site

- 1) Take the metro and get off at the stations “Muzeum” or “Mustek”. You are on the Václavské náměstí.
- 2) Take the metro and get off at the station “Staroměstská”. You are next to the Charles Bridge.

HOW TO REACH the meeting Welcome Party (Masarykova kolej) from the meeting site

Within walking distance from the meeting site.

HOW TO REACH the Concert (Karolinum) from the meeting site

Take the metro, get off at the station “Mustek” and go walk along the Na Příkopě Street, the walking distance is about 5 min.

HOW TO REACH the conference dinner (Prague Castle) from the meeting site

You have these possibilities:

- 1) Take tram No. 2 from the stop “Thakurova”, get off at the stop “Prasny most” and then walk about 10 min.
- 2) Go walk, the walking distance is about 30 min.

The plan of the building at the Meeting place - Faculty of Mechanical Engineering of the Czech Technical University in Praha 6 - Dejvice, Technická 4

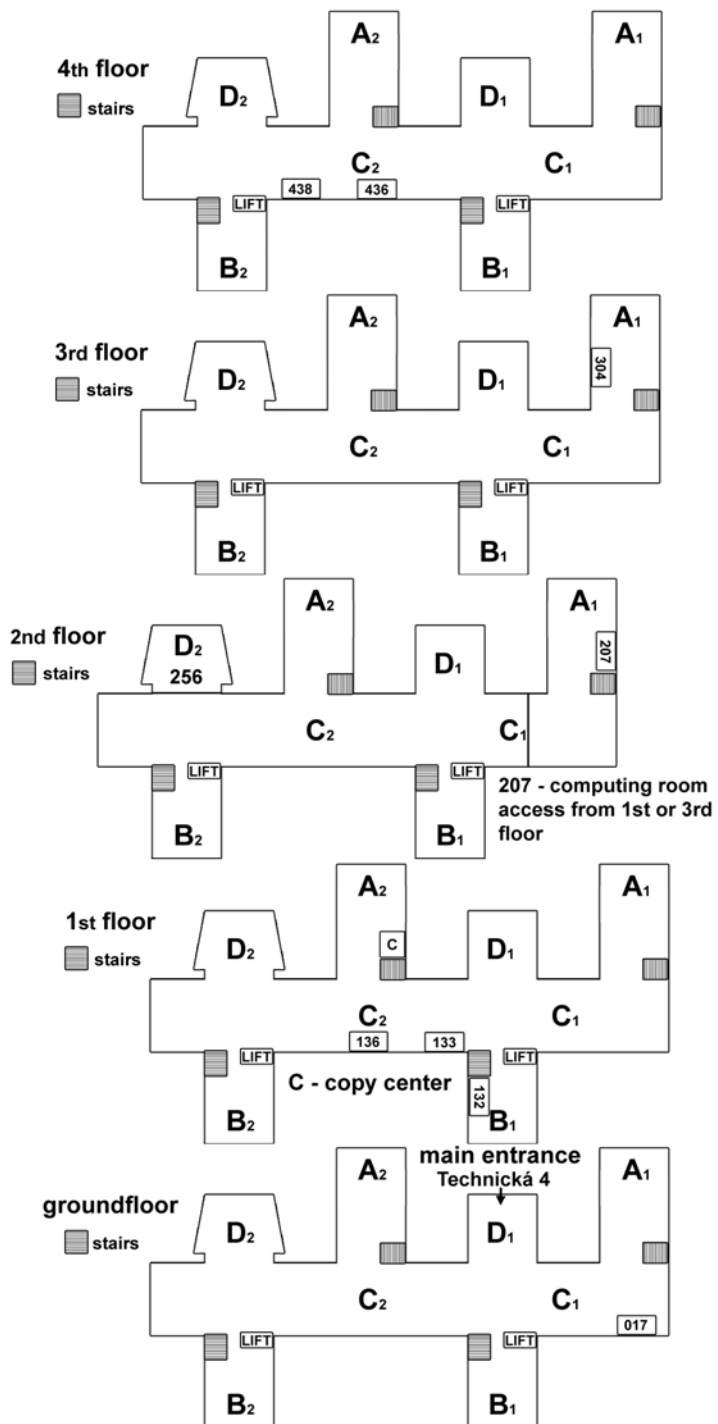

CONTACTS

**ORGANIZATIONAL MATTERS,
REGISTRATION, ACCOMMODATION**

ICARIS Ltd., *Conference Management*

Nám. Dr. Holého 8, CZ-180 00 Praha 8
Czech Republic

E-mail: icaris@icaris.cz

Phones: **+420 284 828 481, 284 828 479**

Fax: **+420 266 312 113**

SCIENTIFIC PROGRAMME

E-mail: aw2003@particle.cz

Phone: **+420 266 052 610**

Fax: **+420 286 890 458**

<http://www.particle.cz/aw2003>

emergency contacts: Miloš Lokajíček +420 604 239 805

Connie Potter +41 792 013 293